

# proximity sensor SIEH-M18B-PO-S-L

Part number: 150463

FESTO

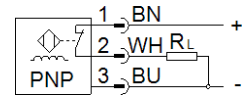
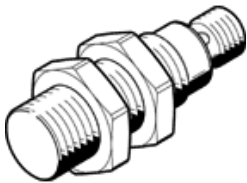

[PDF General operating conditions](#)

[→ Support Portal](#)

## Datasheet product reliability

The information in this "Product reliability data sheet" is based on products being used as intended. This includes complying with all specifications in data sheets, catalogues, user documentation and the general operating conditions. The user alone is responsible for determining whether a product is suitable for a particular application.

Feature	Value
CE mark (see declaration of conformity)	To EU EMC Directive
Mean time to failure (MTTF) <sup>1)</sup>	3.110 Year
Max. switching frequency	1.500 Hz

1) The ascertainment of the MTTF value is generally based on the IEC 61709 "Electric components - Reliability - Reference conditions for failure rates and stress models for conversion" respectively on the SN 29500.