

Cover caps



Application

Cover caps prevent dirt from entering and avoid lacerations.

Comments

Before mounting debur core hole

Technical data

material: PA-GF
 temperature range: -20°C to +85°C

Colours



for profiles without core hole

Rectangle

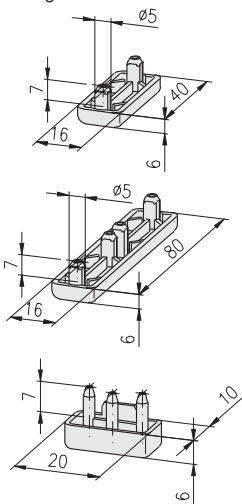

for tube profile

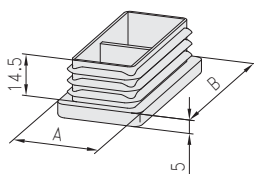

Description	Colour	Weight	Article-No.
Cover cap 16×40, E only for E-Slot	black	3.9 g	1.42.09016040.2

Description	Colour	Weight	Article-No.
Cover cap 16×80, E	grey	7.1 g	1.42.09016080.1
Cover cap 16×80, E only for E-Slot	black	7.1 g	1.42.09016080.2

Description	Colour	Weight	Article-No.
Cover cap 20×10	black	2 g	1.42.20201.2

Description	A×B	Colour	Weight	Article-No.
Cover cap	30×60 for tube profile	black	10.2 g	1.42.217.030060.2
Cover cap	30×100 for tube profile	black	17.7 g	1.42.217.030100.2

for profiles with core hole-Ø6

Soft

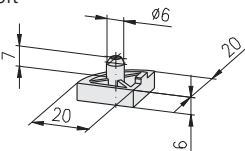

Square

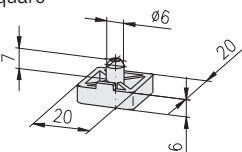

Rectangle

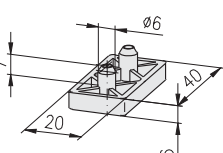

Description	Colour	Weight	Article-No.
Cover cap 20×20	grey	3 g	1.42.10200.1
Cover cap 20×20	black	3 g	1.42.10200.2

Description	Colour	Weight	Article-No.
Cover cap 20×20	grey	3 g	1.42.10202.1
Cover cap 20×20	black	3 g	1.42.10202.2

Description	Colour	Weight	Article-No.
Cover cap 20×40	grey	6 g	1.42.10204.1
Cover cap 20×40	black	6 g	1.42.10204.2

for profiles with core hole-Ø12

Soft

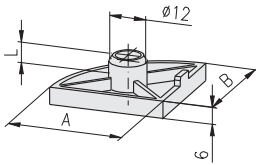

Description	A×B	L	Colour	Weight	Article-No.
Cover cap	30×30	7	grey	5 g	1.42.20300.1
Cover cap	30×30	7	black	5 g	1.42.20300.2
Cover cap	40×40	7	grey	8 g	1.42.20400.1
Cover cap	40×40	7	black	8 g	1.42.20400.2
Cover cap	45×45	14	black	10 g	1.42.2045000.2
Cover cap	50×50	7	grey	12 g	1.42.20500.1
Cover cap	50×50	7	black	12 g	1.42.20500.2

Round

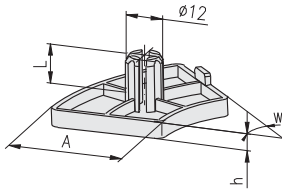

! note "h" !

Description	A	W	h	L	Colour	Weight	Article-No.
Cover cap	40, round	30°	4	14	black	6 g	1.42.2040R30.2
Cover cap	40, round	45°	6	14	black	8 g	1.42.2040R45.2
Cover cap	40, round	60°	6	14	black	12 g	1.42.2040R60.2
Cover cap	40, round	90°	6	14	black	16 g	1.42.2040R90.2

Square

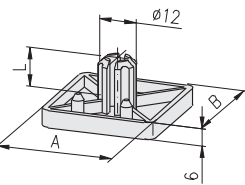

Description	A×B	L	Colour	Weight	Article-No.
Cover cap	30×30	14	grey	6 g	1.42.20303.1
Cover cap	30×30	14	black	6 g	1.42.20303.2
Cover cap	40×40	14	grey	10 g	1.42.20404.1
Cover cap	40×40	14	black	10 g	1.42.20404.2
Cover cap	45×45	14	black	12 g	1.42.2045045.2
Cover cap	50×50	7	grey	15 g	1.42.20505.1
Cover cap	50×50	7	black	15 g	1.42.20505.2
Cover cap	60×60	14	black	18 g	1.42.2060060.2

Rectangle

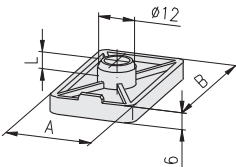

Description	A×B	L	Colour	Weight	Article-No.
Cover cap	20×30	7	grey	4 g	1.42.20203.1
Cover cap	20×30	7	black	4 g	1.42.20203.2
Cover cap	30×50	7	grey	8 g	1.42.20305.1
Cover cap	30×50	7	black	8 g	1.42.20305.2
Cover cap	45×60	14	black	12.1 g	1.42.2045060.2

Rectangle

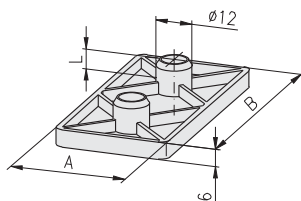

Description	A×B	L	Colour	Weight	Article-No.
Cover cap	30×60	7	grey	8 g	1.42.20306.1
Cover cap	30×60	7	black	8 g	1.42.20306.2
Cover cap	30×100	7	black	20 g	1.42.20310.2
¹⁾ Cover cap	30×150	7	black	27 g	1.42.20315.2
Cover cap	40×80	7	grey	18 g	1.42.20408.1
Cover cap	40×80	7	black	18 g	1.42.20408.2
Cover cap	45×90	14	black	20.5 g	1.42.2045090.2
Cover cap	50×100	7	grey	26 g	1.42.20510.1
Cover cap	50×100	7	black	26 g	1.42.20510.2
Cover cap	50×150	7	black	40 g	1.42.20515.2
Cover cap	60×90	14	black	25.9 g	1.42.2060090.2

¹⁾ only for E-Slot

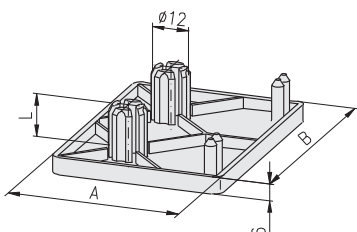

Description	A×B	L	Colour	Weight	Article-No.
Cover cap	60×80	14	black	21.4 g	1.42.2060080.2

for profiles with core hole-Ø12

Square

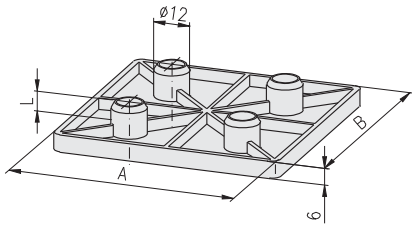

Description	A×B	L	Colour	Weight	Article-No.
Cover cap	80×80	7	black	34 g	1.42.20808.2
Cover cap	90×90	14	black	42 g	1.42.2090090.2
Cover cap	100×100	7	black	52 g	1.42.21010.2

Ø48 for hand rail profile

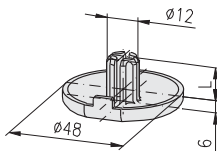

C **Technical data**
material: PA-GF

Description	L	Colour	Weight	Article-No.
Cover cap Ø48 for hand rail profile	14	grey	1.8 g	1.42.2048R00.1
Cover cap Ø48 for hand rail profile	14	black	1.8 g	1.42.2048R00.2