

Corner elements  
for wire net mounting profile

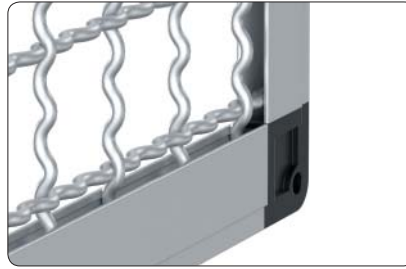

Application

This mounting profile allows simple and safe installation of screens

Comments

Wire net mounting profile ↗ 1.19.1423...

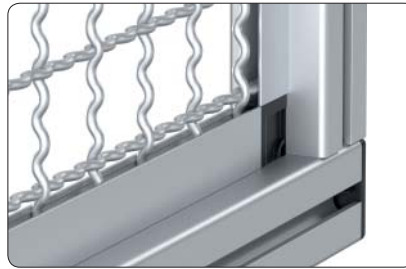

Mounting in the profile slot

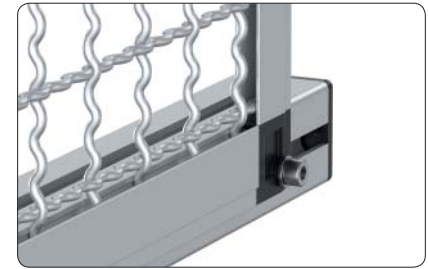

Fastening from the outside

Technical data

material: PA - GF  
colour: black

Outside corner

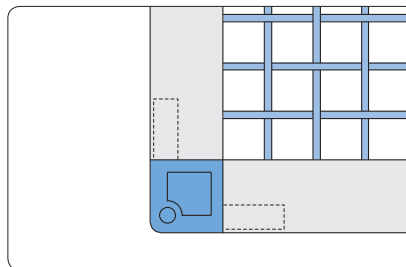
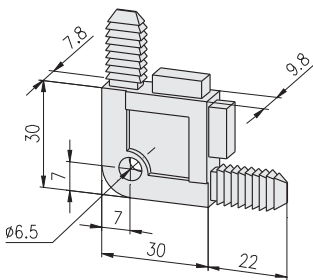

Outside corner

Description

Corner element - outside

Weight

13 g

Article-No.

1.81.1010

Inside corner

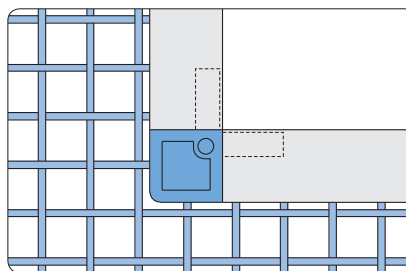
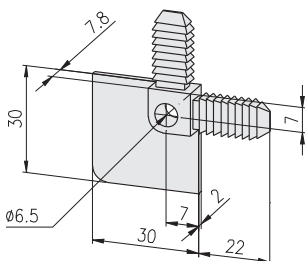

Inside corner

Description

Corner element - inside

Weight

6 g

Article-No.

1.81.1020

**Corner element 33  
for wire net mounting profile 33×10**

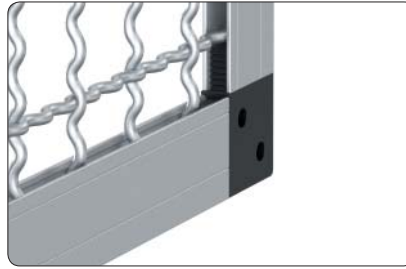

**Application**

This profile allows simple and safe installation of wire nets

**Comments**

Wire net mounting profile 33×10  
[➤ 1.19.1423...](#)

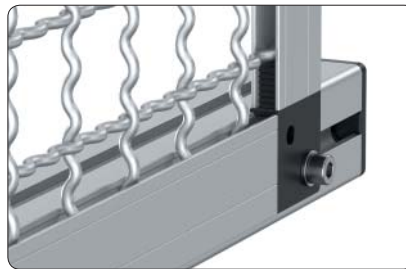

Outside mounting

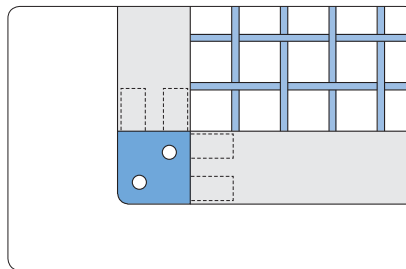

Outside corner

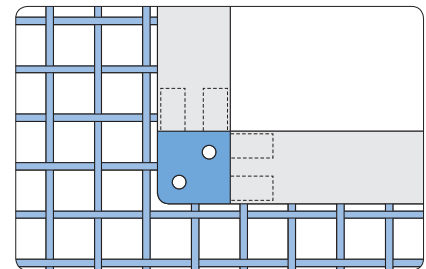

Inside corner

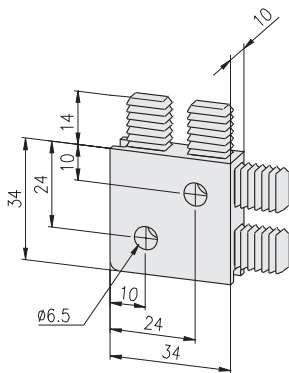

**Technical data**

material: PA - GF  
 colour: black

Description	Weight	Article-No.
Corner element 33	16 g	1.81.23310

Mounting sockets

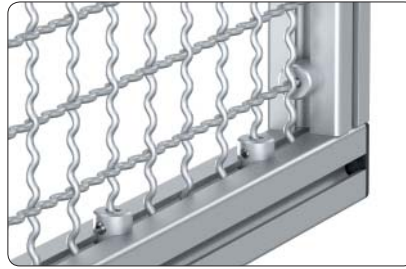

Application

For stable and vibration free fastening of wire nets

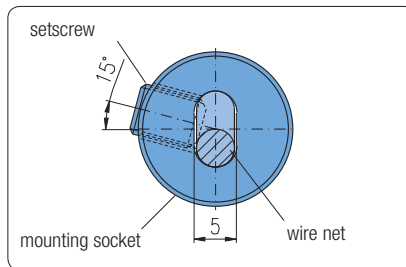
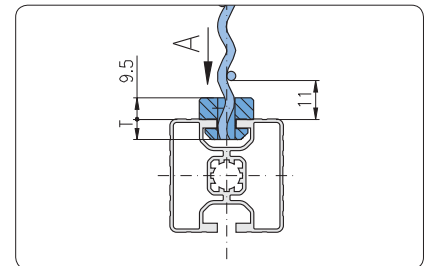
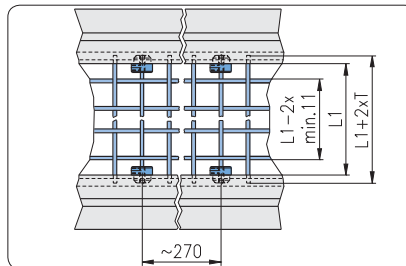

Assembly

- plug terminal sockets at a distance of about 270 mm on the wire net
- push on profile
- rotate mounting sockets with headless setscrew DIN 913 M6×8 at an angle of 15°

View „A“

Technical data

material:  
 mounting socket: aluminium, natural anodised  
 setscrew: steel, galvanised

Delivery unit

Mounting socket incl. setscrew

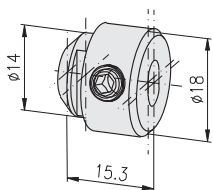

H F E

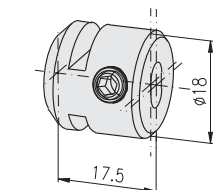

H F E3

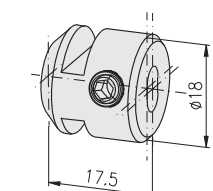

H F E4

Description	T	Weight	Article-No.
Mounting socket, F	5	6 g	1.81.510F

Description	T	Weight	Article-No.
Mounting socket, E3	8	6 g	1.81.510E3

Description	T	Weight	Article-No.
Mounting socket, E4	8	6 g	1.81.510E4

Panel elements

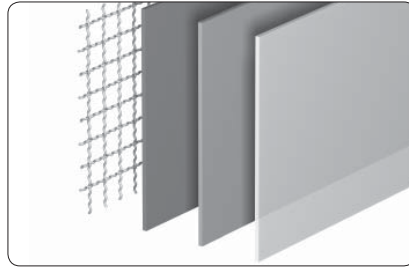

**Application**

Panel elements to cover machine frames, work stations, partition walls.



Panel element, fixing directly in the slot

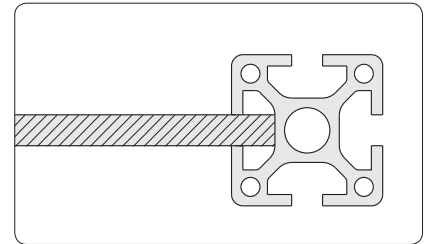

Installation accessories ↗ 1.41



Panel elements close to the outer contour by subsequent slitting of the profiles

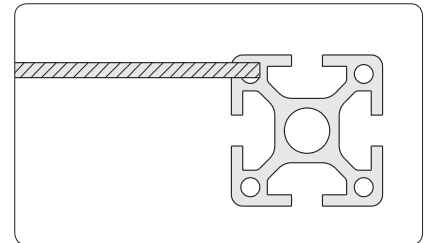

Special slits ↗ 1.1E.01



Panel elements close to the outer contour by applying panel profiles

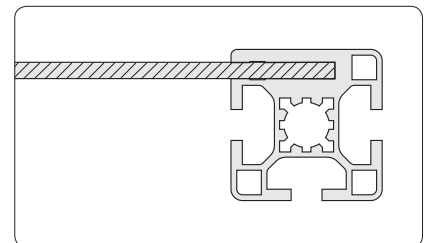

Panel profiles ↗ 1.14



Panel elements close to the outer contour by applying wire net profiles

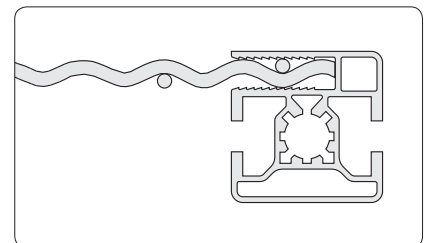

Wire net profiles ↗ 1.15



Panel elements close to the outer contour by fixing with angle or mounting block

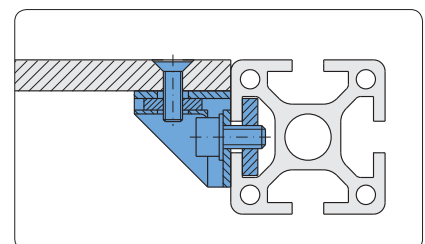

Mounting blocks ↗ 1.64

**Chipboards**  
**both sides coated with melamine**

Technical data	
surface:	both sides coated with melamine
structure:	mini pearl
RAL 7035:	light grey
formaldehydmission:	complies to safety standards §9 paragraph 3
light-fastness:	point 6 as per DIN 53799
temperature resistance:	- 25°C to 130°C
chemical resistance:	resistant against organic food, light acid contents and alkaline solution, gasoline, oil, tested as per DIN 53799
chipboard:	high frequency glued laminated chipboard
Technical values on DIN 68765 and 53799	
bulk density:	approx. 700 kg/m <sup>3</sup>
thickness tolerance:	+0.5 -0.3 mm
weight:	S = 8 mm    5.6 kg/m <sup>2</sup> S = 16 mm    11.2 kg/m <sup>2</sup> S = 19 mm    13.3 kg/m <sup>2</sup>
cut to length:	1.82.□□□-99/□□□□×□□□□ 1.82.□□□-99/□□□□×□□□□    type 1.82.□□□-99/□□□□×□□□□    length×width in mm

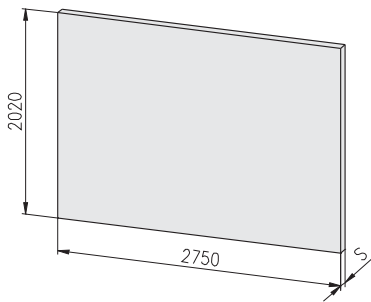

Description	S	RAL	Weight	Article-No.
Chipboard	8	7035	32 kg	1.82.083.00
Chipboard	16	7035	64 kg	1.82.163.00
Chipboard	19	7035	75 kg	1.82.193.00

**Solid plastic panels**  
**coated with melamine**

Technical data	
surface:	both sides coated with melamine
structure:	mini pearl
RAL 7035:	light grey
solid plastic panel:	made of Phenolplastic high pressure plate (HPL) of laminated material with all generally known merits of this substance.
Technical values on DIN 19926 and 53799	
bulk density:	approx. 1,500 kg/m <sup>3</sup>
thickness tolerance:	-0.6 mm
weight:	S = 4 mm    6 kg/m <sup>2</sup> S = 8 mm    12 kg/m <sup>2</sup>
cut to length:	1.83.□□□-99/□□□□×□□□□ 1.83.□□□-99/□□□□×□□□□    type 1.83.□□□-99/□□□□×□□□□    length×width in mm

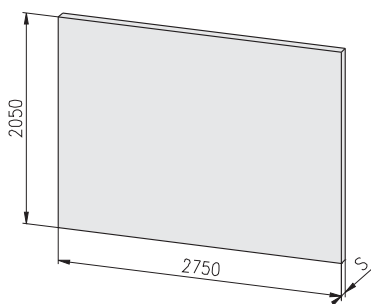

Description	S	RAL	Weight	Article-No.
Solid plastic panel	4	7035	33 kg	1.83.043.00
Solid plastic panel	8	7035	66 kg	1.83.083.00

Alu-plastic composite panels

Technical data	
alu-plastic composite panel:	PE with alu coating on both sides
surface:	natural anodised, E6/EV1
temperature resistance:	- 50°C to 80°C
chemical resistance:	resistant against organic food, light acid contents and alkaline solutions, gasoline, oil
thickness tolerance:	-0.6 mm
weight:	S = 4 mm 5.5 kg/m <sup>2</sup> S = 6 mm 7.3 kg/m <sup>2</sup>
cut to length:	1.85.□□□-99/□□□□×□□□□ 1.85.□□□-99/□□□□×□□□□ type 1.85.□□□-99/□□□□×□□□□ length×width in mm

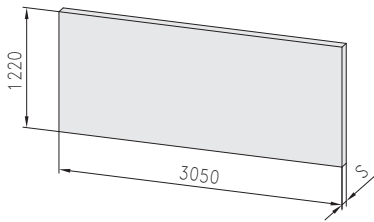

Description	S	Weight	Article-No.
Alu-plastic composite panel	4	20.5 kg	1.85.040.00
Alu-plastic composite panel	6	27.2 kg	1.85.060.00

Polycarbonate (Makrolon)

Application

Doors, panels and guards with stringent security requirements as polycarbonate offers high impact resistance and strength against breakage

Technical data	
thickness tolerance:	+0.8 mm
weight:	S = 4 mm 4.8 kg/m <sup>2</sup> S = 5 mm 6.0 kg/m <sup>2</sup> S = 6 mm 7.2 kg/m <sup>2</sup> S = 8 mm 9.6 kg/m <sup>2</sup>
cut to length:	1.87.□□□-99/□□□□×□□□□ 1.87.□□□-99/□□□□×□□□□ type 1.87.□□□-99/□□□□×□□□□ length×width in mm
Mechanical properties at 20 °C	
maximum extent of flex	68.7 MN/m <sup>2</sup>
break / shear point	> 110.0 %
compression	78.5 MN/m <sup>2</sup>
elasticity	2,256.0 MN/m <sup>2</sup>
marring resistance	392.4 J/m <sup>2</sup>
impact resistance (kJ/m <sup>2</sup> )	no break
tensile strength	68.7 MN/m <sup>2</sup>
Thermal properties	
temperature distortion according to 'Vicat'	170 °C
melting point	170 °C
temperature range under static load	-100 °C to 130 °C

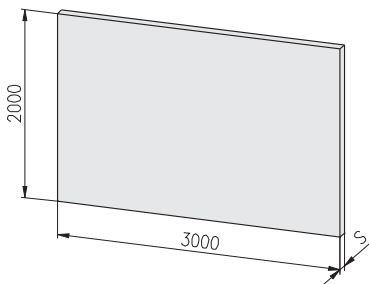

Description	S	Colour	Weight	Article-No.
Polycarbonate	4	transparent	28.8 kg	1.87.041.00
Polycarbonate	4	UV bronze 2850	28.8 kg	1.87.042.00
Polycarbonate	5	transparent	36.0 kg	1.87.051.00
Polycarbonate	5	UV bronze 2850	36.0 kg	1.87.052.00
Polycarbonate	6	transparent	43.2 kg	1.87.061.00
Polycarbonate	6	UV bronze 2850	43.2 kg	1.87.062.00
Polycarbonate	8	transparent	57.6 kg	1.87.081.00
Polycarbonate	8	UV bronze 2850	57.6 kg	1.87.082.00

Wire net, Alu

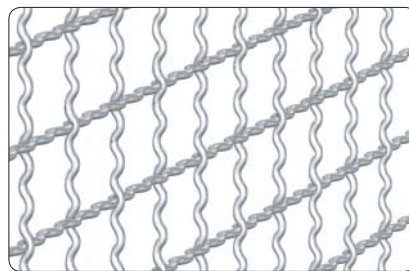





Application

For protective coverings and partition walls

Comments

Mounting in the profile:

- with sponge rubber  1.41.6□□
- with wire net m. prof.  1.19.1423...
- with wedge profile  1.41.51E□.□
- with framing profile  1.41.710.□
- with mounting sockets  1.81.510□□

Technical data	
material:	Aluminium
surface:	bare
weight:	3×20×20 mm 1.85 kg/m <sup>2</sup> 4×30×30 mm 2.25 kg/m <sup>2</sup>
length of ring:	25 m
cut to length:	1.88.□□□-99/□□□□×□□□□ 1.88.□□□-99/□□□□×□□□□ type 1.88.□□□-99/□□□□×□□□□ length×width in mm

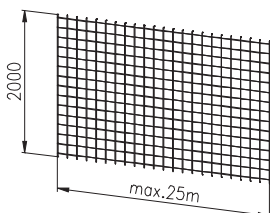

Description	Weight	Article-No.
Wire net, Alu 3×20×20	92.5 kg	1.88.322.00
Wire net, Alu 4×30×30	112.5 kg	1.88.433.00